

-- The below pages contain drawings for the Cherubini Hunter 25 and 27-- From the Hunter Owner's Manual

Hunter 25

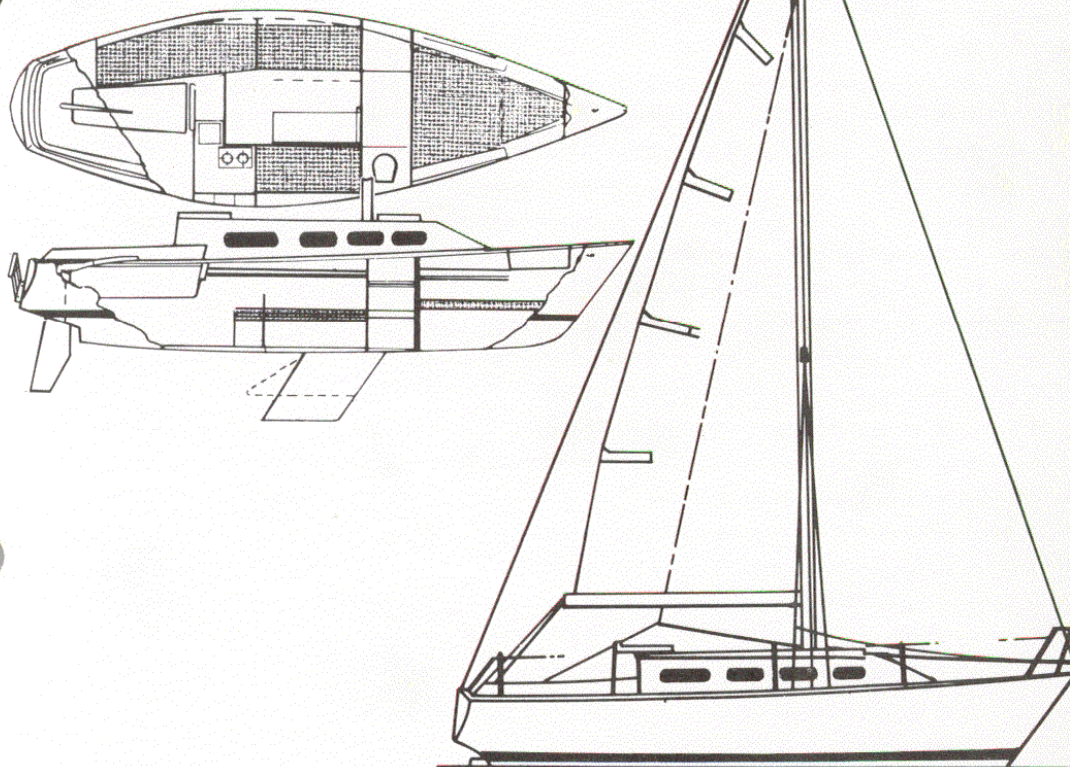

SPECIFICATIONS:

E (Mainsail foot)	8'0"	2.40 m.
J (Foretriangle base)	10'6"	3.15 m.
P (Mainsail luff)	24'9 1/2"	7.54 m.
I (Foretriangle ht.)	30'0"	9.10 m.
L.O.A.	25'0"	7.60 m.
L.W.L.	20'2"	6.15 m.
Beam	8'0"	2.40 m.
Sail area	256 sq. ft.	23.78 sq. m.
Displacement	4,400 lbs.	1,995.80 kg.
Ballast	Shoal 2,000 lbs.	908.00
	Deep 1,800 lbs.	817.20 kg.
Draft	Shoal 2'11"	.88 m.
	Deep 3'11"	1.18 m.
Mast height	28'8"	8.70 m.
from waterline	34'1"	10.32 m.

Hunter 25

WIRING DIAGRAM (DC)

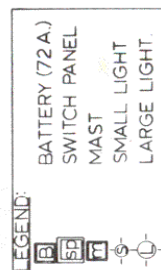
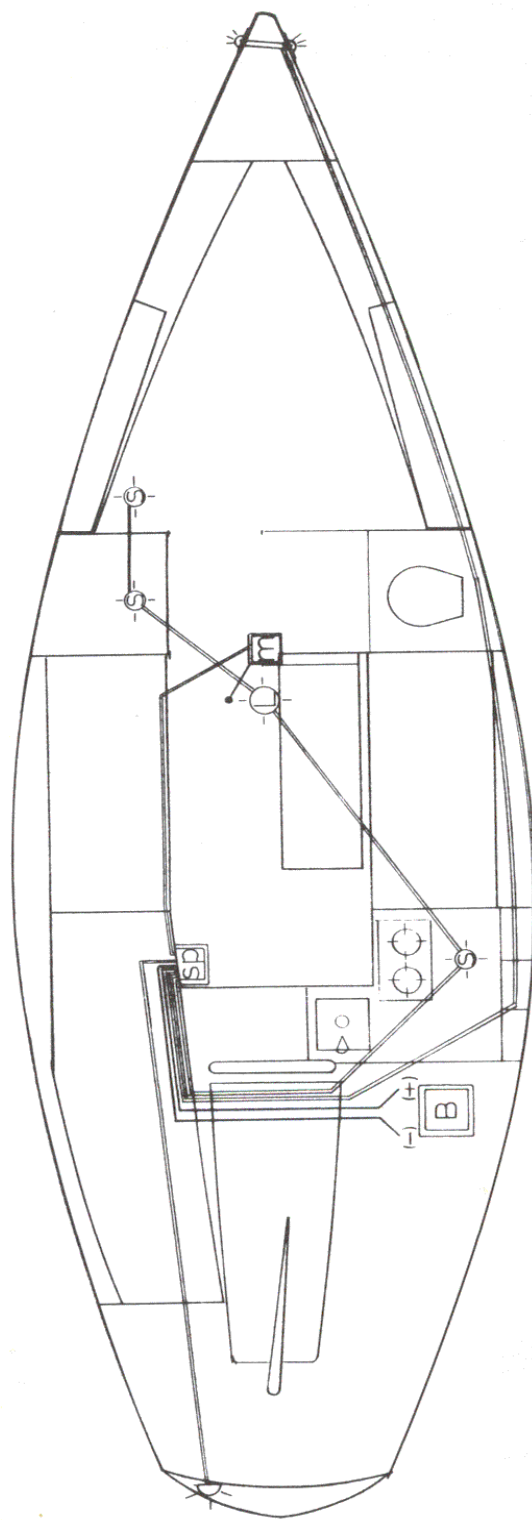

WIRING NOTES:

COLOR	GAUGE	APPLICATION
RED	6	BATTERY CABLE
WHITE	8	MAST GROUND
BLUE	16	CABIN LIGHTS
GREY	16	RUNNING LIGHTS (BOW)
WHITE	16	" (STERN)
RED	16	STEERING LIGHTS

ALL LEADS ARE RUN WITH A BLACK GROUND OF EQUAL GAUGE. THESE ARE CONNECTED TO A COMMON GROUND AT THE SWITCH PANEL.

THE MAST GROUND HAS NO LEAD.

Hunter 25

PLUMBING DIAGRAM

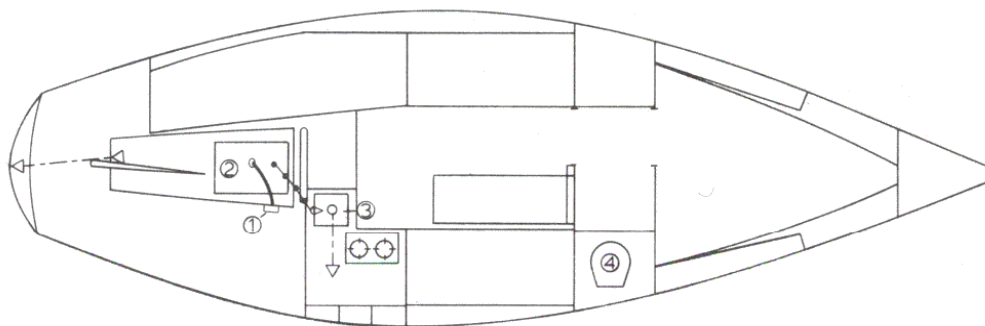

LEGEND:
① WATER FILL PLATE (UNDER STBD COCKPIT SEAT)
② 15 GAL. WATER BAG
③ GALLEY
④ MANSFIELD SANI-POTTI (PORTABLE)

SYMBOLS:
—•—•— 5/8" WHITE REINF. HOSE
- - - - - 1-1/2" SHIELD FLEX (GRN)
— — — — — 1-1/2" SHIELDVAC
W/HOSE CUFFS
△ THRU-HULL (PLASTIC) — —
SIZE TO MATCH AT-
TACHED HOSE

Hunter 27

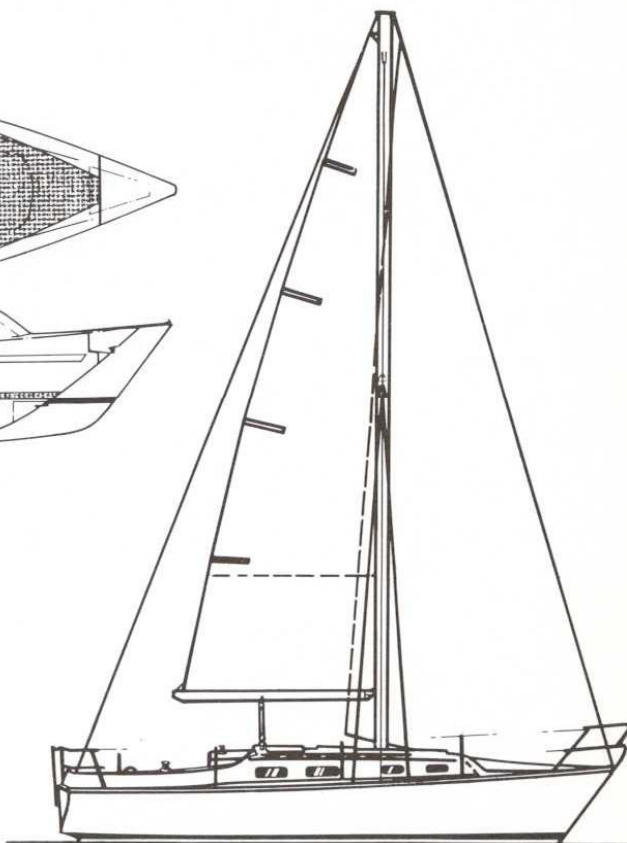
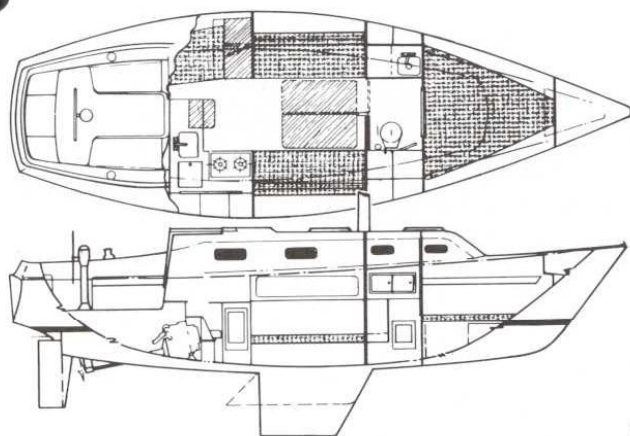

SPECIFICATIONS:

E (Mainsail foot)	9'11"	2.85 m.
J (Foretriangle base)	11'3"	3.37 m.
P (Mainsail luff)	32'4"	9.86 m.
I (Foretriangle base)	37'8"	11.48 m.
L.O.A.	27'2"	8.20 m.
L.W.L.	22'0"	6.70 m.
Beam	9'3"	2.77 m.
Sail area	360.2 sq. ft.	33.56 sq. m.
Displacement	7,000 lbs.	3,175.20 kg.
Ballast	Shoal 3,200 lbs.	1,452.8 kg.
	Deep 3,000 lbs.	1,362.0 kg.
Draft	Shoal 3'3"	.97 m.
	Deep 4'3"	1.27 m.
Mast height	36'3"	11.05 m.
from waterline	40'11"	12.47 m.
Headroom	6'1"	1.85 m.

Hunter 27

PLUMBING DIAGRAM

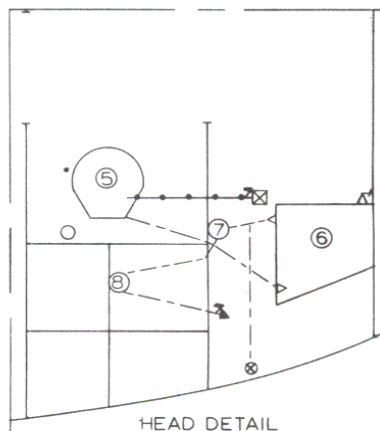
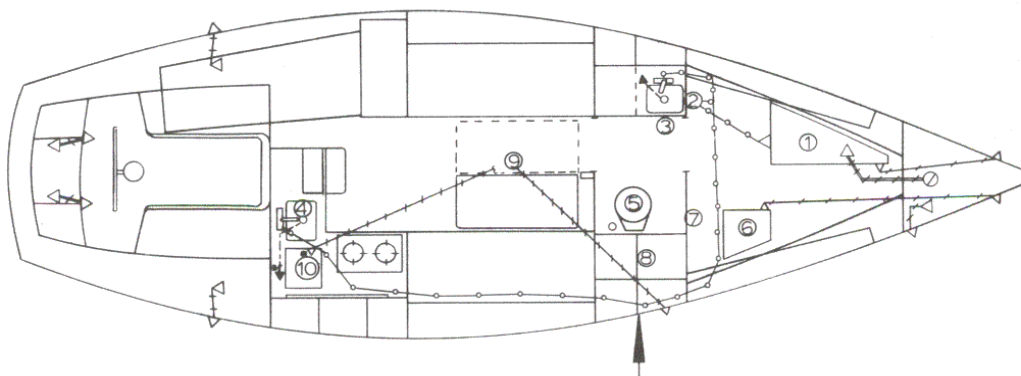

SUBSYSTEMS:
FRESH WATER
WASTE DISPOSAL
DRAINS

HEAD DETAIL

LEGEND:

- ① FRESH WATER TANK
- ② WATER PUMP
- ③ VANITY
- ④ GALLEY
- ⑤ MANSFIELD HEAD
- ⑥ HOLDING TANK
- ⑦ N°10 WHALE GUSHER (HAND PUMP)
- ⑧ 1-1/2" VENTED LOOP (BRONZE)
- ⑨ BILGE PUMP
- ⑩ ICE BOX

HOSES & FITTINGS:

- 5/8" WHITE REINF. HOSE
- 5/8" BLACK HOSE (HEAD)
- /— 3/4" SHIELDVAC (W/CUFFS)
- /— 1-1/2" SHIELDVAC (W/CUFFS)
- /— 1-1/4" SHIELDFLEX (GREEN)
- /— 1-1/2" SHIELDFLEX (GREEN)
- △ THRU HULL (PLASTIC)
- ▲ THRU HULL (BRONZE)
- DECK PLATE (WATER)
- ⊗ DECK PLATE (WASTE)
- ⊠ SALT WATER PICKUP
- 7 GATE VALVE

Hunter 27

WIRING DIAGRAM (AC)

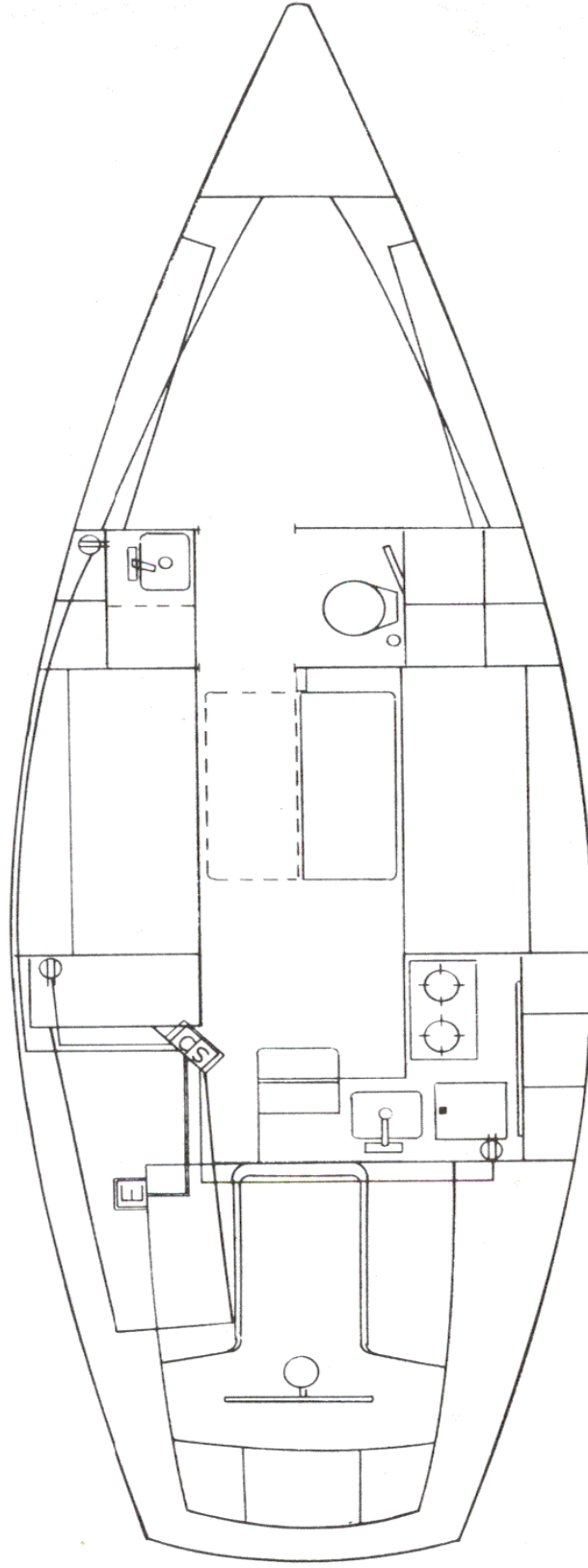

LEGEND:		ELECTRICAL DECK PLATE
		SWITCH PANEL
		110V OUTLET
		10/3 MARINE POWER CABLE (AC SUPPLY)
		14/3 MARINE POWER CABLE (TO OUTLETS)

Hunter 27

WIRING DIAGRAM (DC)

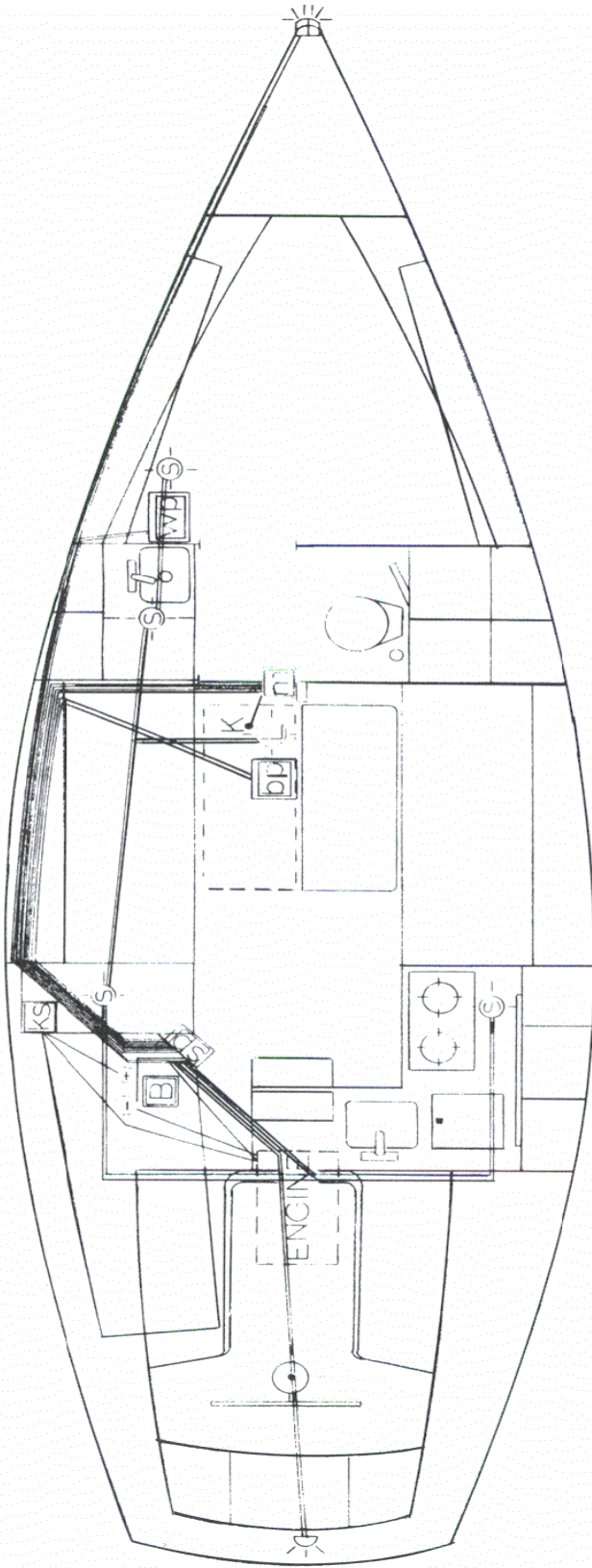

LEGEND:	
	BATTERY (72 A.)
	SWITCH PANEL
	KEY SWITCH
	WATER PUMP
	BILGE PUMP (400 GPH)
	MAST POST
	SMALL LIGHT
	LARGE LIGHT
	KEEL

WIRING NOTES:	
COLOR	GAUGE
RED	4
WHITE	8
RED	10
RED	12
BLUE	16
WHITE	16
GREEN	16
RED	16
BROWN	16
ALL LEADS 12 TO 16 GAUGE ARE RUN WITH A BLACK GROUND OF EQUAL GAUGE. THESE ARE CONNECTED TO A COMMON GROUND AT THE SWITCH PANEL WHICH IS GROUNDED TO THE BATTERY (-) WITH A 10 GAUGE BLACK WIRE.	
APPLICATION	
BATTERY CABLE /KEY SWITCH	
MAST GROUND	
DC SUPPLY TO SWITCH PANEL	
WATER PUMP	
CABIN LIGHTS	
RUNNING LIGHTS (BOW)	
STEERING LIGHTS (STERN/COMPASS)	
ANCHOR LIGHT	
BILGE PUMP	